

Acer 'Autumn Blaze'



Gleditsia triacanthos



Gymnocladus dioica



Quercus 'Crimson Spire'



Buxus 'Winter Gem'



Hydrangea 'Incrediball'



Rhus aromatica 'Gro Low'



Juniperus 'Sea Green'



Calamagrostis 'Karl Foerster'



Panicum 'Northwind'



Liriope muscari

SEED MIX

ERNST SEED NATIVE DETENTION AREA MIX: 8 lbs

- 32% Panicum clandestinum 'Tioga' Deertongue 'Tioga'
- 20% Carex vulpinoidea, PA Ecotype Fox Sedge, PA Ecotype
- 20% Elymus virginicus, PA Ecotype Virginia Wildrye, PA Ecotype
- 20% Panicum virgatum 'Shawnee' Switchgrass 'Shawnee'
- 4% Agrostis perennans, NY Ecotype Autumn Bentgrass, Albany Pine Bush-NY Ecotype
- 2% Juncus tenuis, PA Ecotype Path Rush, PA Ecotype
- 1% Juncus effusus Soft Rush
- 1% Panicum rigidulum, PA Ecotype Redtop Panicgrass, PA Ecotype

PLANT SCHEDULE

TREES						
	CODE	QTY	BOTANICAL NAME	COMMON NAME	SIZE	
	ACE AU3	30	Acer rubrum 'Autumn Blaze'	Autumn Blaze Red Maple	2.5-3"	
	GLE TTI	25	Gleditsia triacanthos f. inermis	Thornless Honey Locust	2.5-3"	
	GYM KEN	31	Gymnocladus dioica	Kentucky Coffeetree	2.5-3"	
	QUE CRI	42	Quercus robur x alba 'Crimschmidt' TM	Crimson Spire Oak	2.5-3"	
SHRUBS						
	CODE	QTY	BOTANICAL NAME	COMMON NAME	SIZE	
	BUX GE2	89	Buxus microphylla 'Winter Gem'	Globe Winter Gem Boxwood	30-36"	
	HYD AR2	62	Hydrangea arborescens 'Incrediball'	Incrediball White Hydrangea	5 Gal	
	JUN SEA	340	Juniperus x pfitzeriana 'Sea Green'	Sea Green Juniper	3 Gal	
	RHU GRO	138	Rhus aromatica 'Gro-Low'	Gro-Low Fragrant Sumac	3 Gal	
GRASSES						
	CODE	QTY	BOTANICAL NAME	COMMON NAME	SIZE	
	CAL KAR	536	Calamagrostis x acutiflora 'Karl Foerster'	Feather Reed Grass	2 Gal	
	PAN NO4	306	Panicum virgatum 'Northwind'	Switch Grass	2 Gal	
GROUND COVERS						
	CODE	QTY	BOTANICAL NAME	COMMON NAME	SIZE	SPACING
	LIR MUS	1,804	Liriope muscari	Lily Turf	1 Gal	18" o.c.

TO SCALE WHEN PLOTTED ON 24x36
PROGRESS SET NOT FOR CONSTRUCTION

SHEET NO.
L-701
PLANTING PLAN

REVISIONS:
12/5/19

DATE: OCTOBER 4, 2019
DRAWN BY: BMY
JOB NO.: 100117
SCALE: 1" = 40'
FILENAME: 2019_1205_Oak Tree Apartments

OAK TREE APARTMENTS
THIELLS, NY 10984

SURVEYOR:
178 elizabeth st
Pearl River, NY 10965
p 845.365.4995 | f 914.361.4473
yostdesign.com

YOST DESIGN
LANDSCAPE ARCHITECTURE

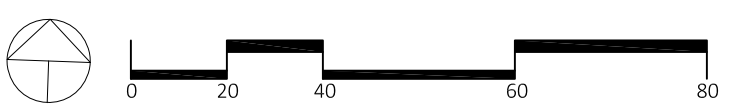
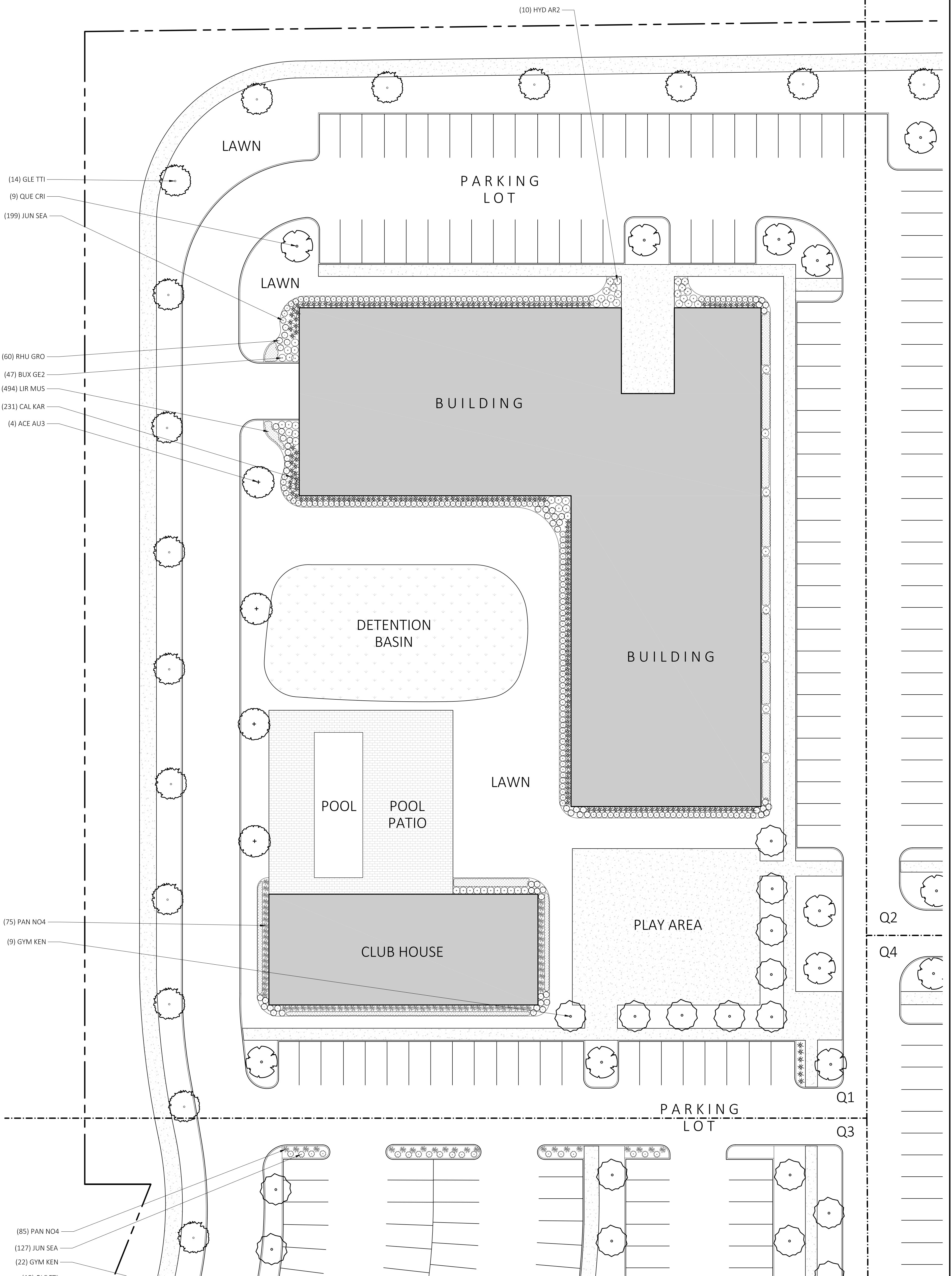

TO SCALE WHEN PLOTTED ON 24x36

PROGRESS SET NOT FOR CONSTRUCTION

YOST
DESIGN
 LANDSCAPE
 ARCHITECTURE

178 elizabeth st
 Pearl River, NY 10955
 p 845.365.4595 | f 914.361.4473
 yostdesign.com

SURVEYOR:

OAK TREE APARTMENTS
 THIELLS, NY 10984
 QUADRANT 1

DATE: OCTOBER 4, 2019
 DRAWN BY: BMY
 JOB NO.: 100117
 SCALE: 1" = 20'
 FILENAME: 2019_1005 Oak Tree
 Apartments

REVISIONS:
 12/5/19

PLANTING
PLAN

SHEET NO.

L-701

SHEET: 2 of 5

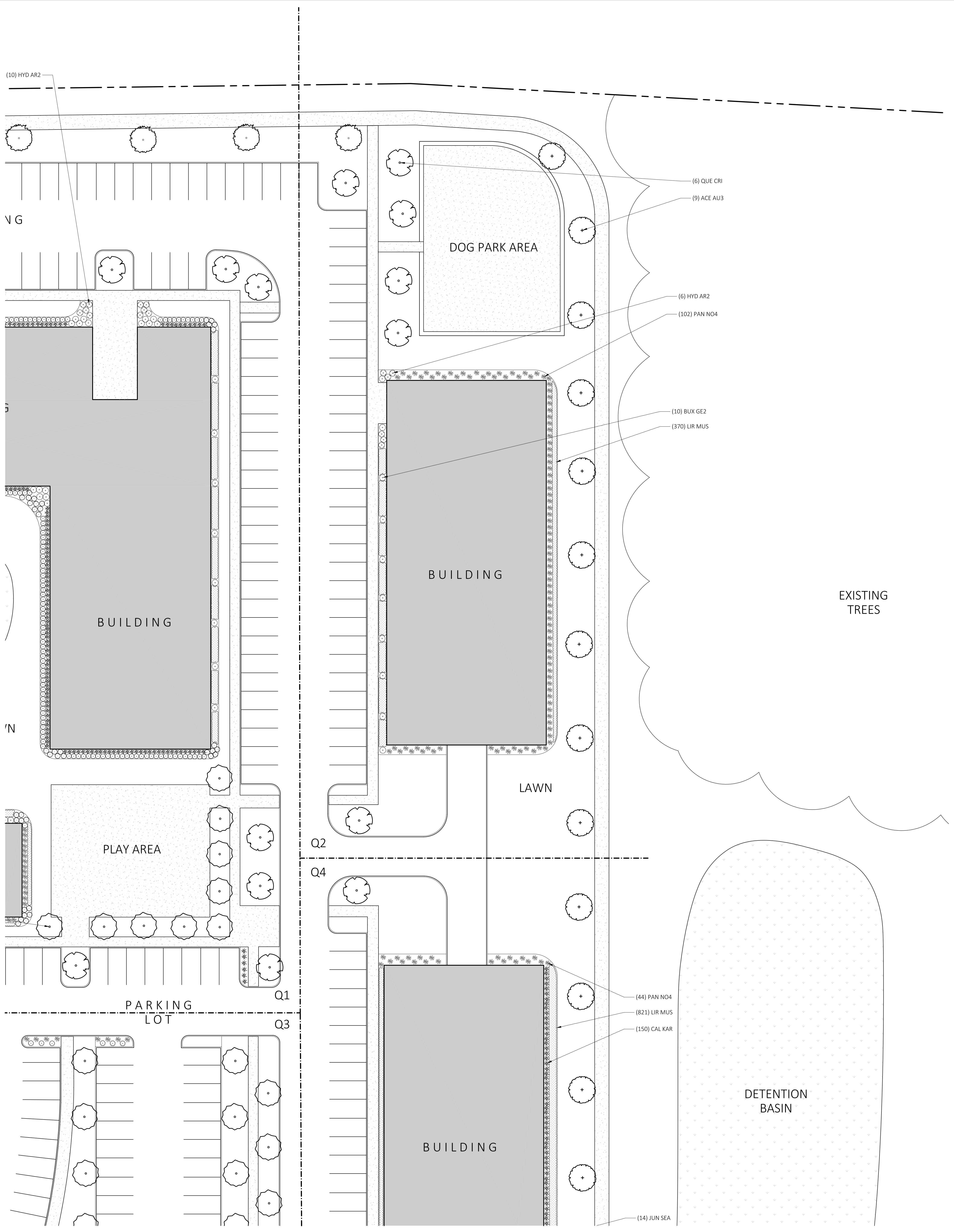

TO SCALE WHEN PLOTTED ON 24x36
 PROGRESS SET NOT FOR CONSTRUCTION

YOST
 DESIGN
 LANDSCAPE
 ARCHITECTURE

178 elizabeth st
 Pearl River, NY 10965
 p 845.365.4995 | f 914.361.4473
 yostdesign.com

OAK TREE APARTMENTS
 THIELLS, NY 10984
 QUADRANT 2

DATE: OCTOBER 4, 2019
 DRAWN BY: BMY
 JOB NO: 100117
 SCALE: 1" = 20'
 FILENAME: 2019_1205 Oak Tree Apartments

REVISIONS:
 12/5/19

SHEET NO.
L-701
 SHEET: 3 OF 5

SURVEYOR:
 BIRNBAUM ASSOCIATES, L.P. Registered Landscape Architect

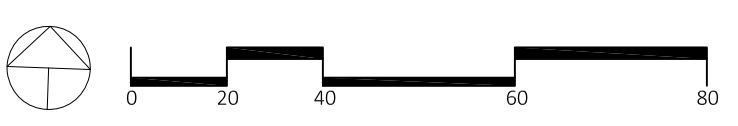
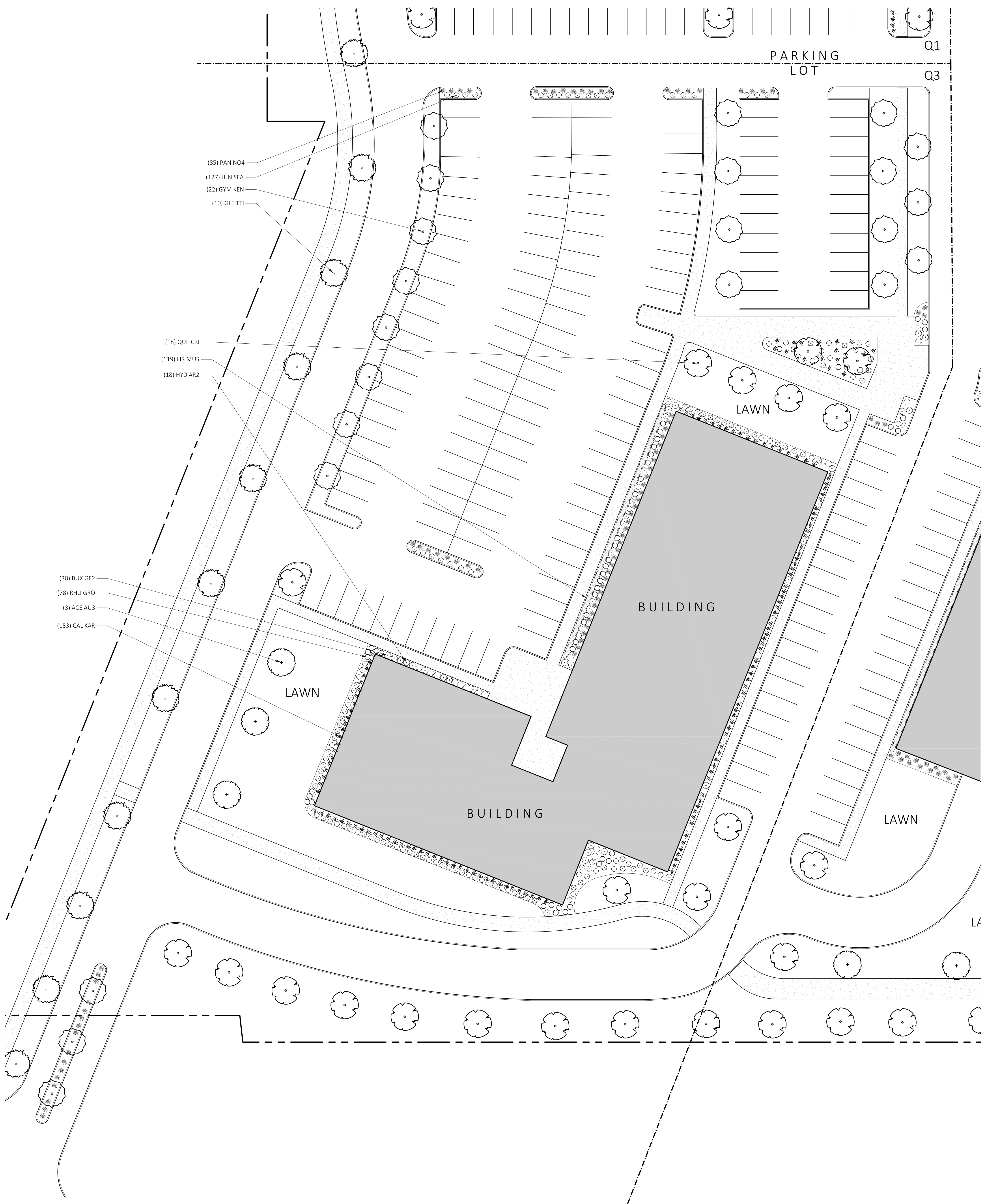

TO SCALE WHEN PLOTTED ON 24x36
 PROGRESS SET NOT FOR CONSTRUCTION

SHEET NO.
L-701
 SHEET: 4 of 5

BIRDS AND INSECTS: Registered Landscape Architect
PLANTING PLAN
 DATE: OCTOBER 4, 2019
 DRAWN BY: BMY
 JOB NO.: 100117
 SCALE: 1" = 20'
 FILENAME: 2019_1205 Oak Tree Apartments
 REVISIONS:
 12/5/19

OAK TREE APARTMENTS

THIELLS, NY 10984
 QUADRANT 3

SURVEYOR:
YOST DESIGN
 LANDSCAPE ARCHITECTURE
 178 elizabeth st
 Pearl River, NY 10965
 p 845.365.4595 | f 914.361.4473
 yostdesign.com

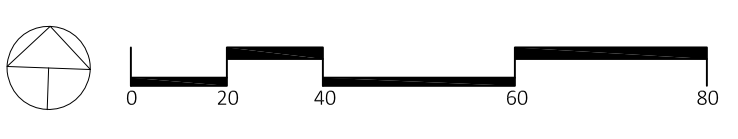
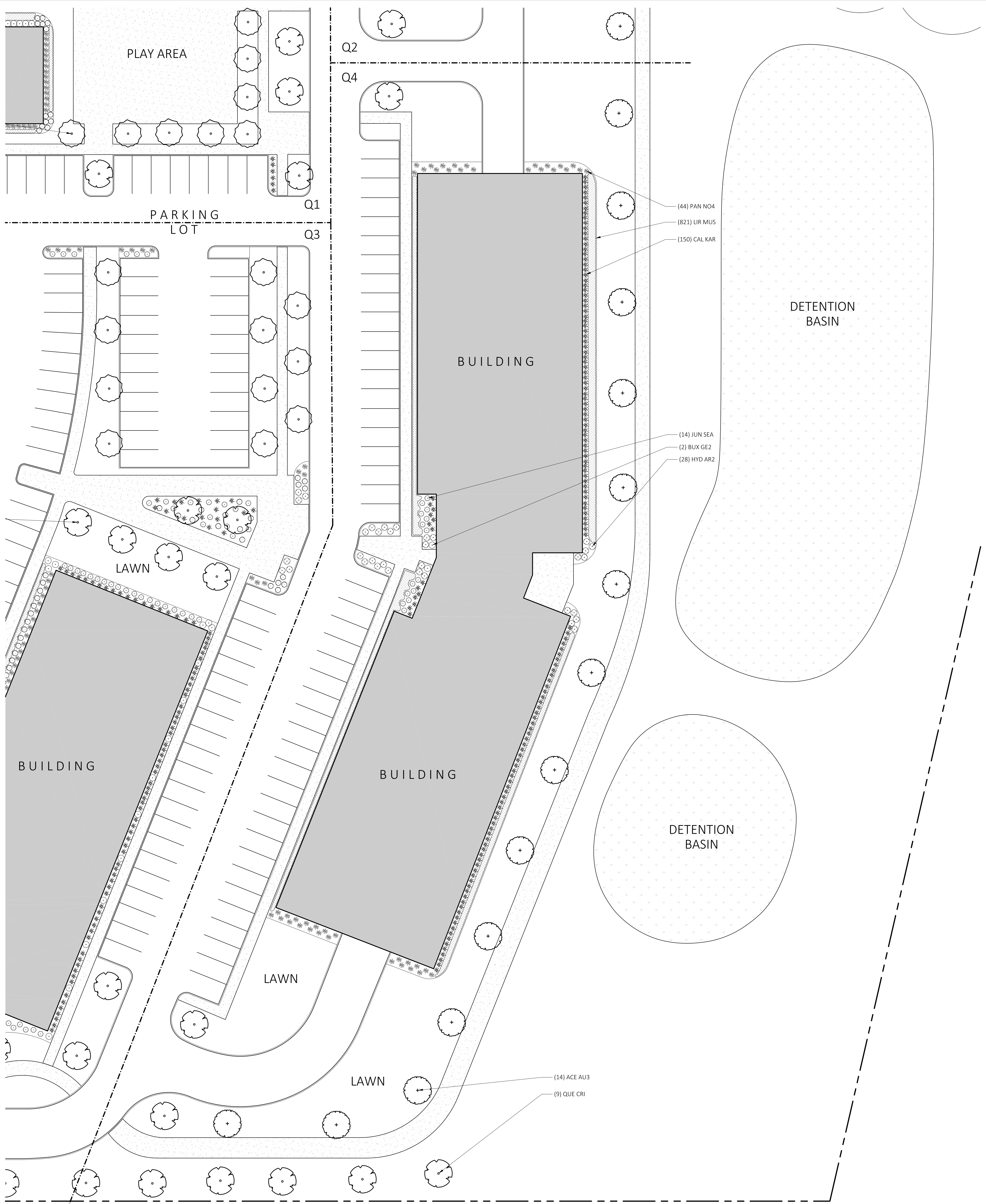

TO SCALE WHEN PLOTTED ON 24x36
 PROGRESS SET NOT FOR CONSTRUCTION

PLANTING PLAN
 SHEET NO. **L-701**
 SHEET: 5 of 5

DATE: OCTOBER 4, 2019
 DRAWN BY: BMY
 JOB NO.: 100117
 SCALE: 1" = 20'
 FILENAME: 2019_1205 Oak Tree Apartments

REVISIONS:
 12/5/19

OAK TREE APARTMENTS

THIELLS, NY 10984
 QUADRANT 4

YO ST DESIGN
 LANDSCAPE ARCHITECTURE
 178 elizabeth st
 Pearl river, ny 10965
 p 845.365.4995 | f 914.361.4473
 yostdesign.com

SURVEYOR: